

# Adapter set for MNR 100-UNI Elec Case

## EXPLANATION & INSTRUCTIONS

Available adapters in your universal carrying case for electrical calibrators:

### 1x core part

- Including PVC plates = Fluke 610xA, Fluke 57X0A
- Excluding PVC plates = Fluke 5730A

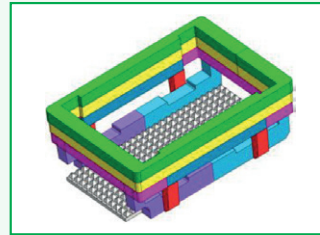

### 2x Adapter-1

Used as an insert into the core part for:

- 1x = Fluke 5320A
- 2x = Fluke 55x0A
- Turned 180° = Fluke 55x2A

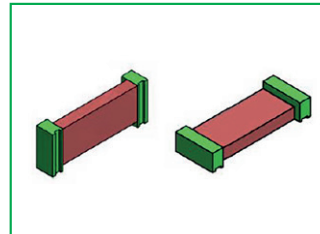

### 1x Adapter-2

Used as an insert into the core part for:

- Fluke 8508A
- Keysight 3485A
- Wavetek 9100

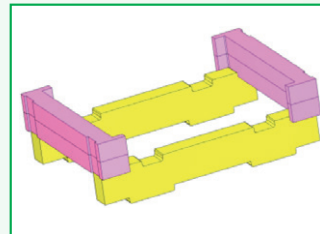

### 1x Adapter-3

Used as an insert into the core part for:

- 1x End part = Fluke 5700A
- 1x End part = Fluke 5725A (together with Adapter-4)

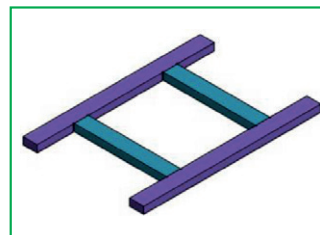

### 1x Adapter-4

Used as height compensation for:

- Fluke 5725A (together with Adapter-3)

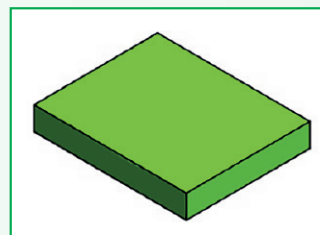

## INSTRUCTIONS

### Fluke 6100A

= core part, without other adapter parts

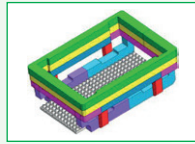

### Fluke 57X0A

### Fluke 5730A

(without PVC plates)

= core part + Adapter-3

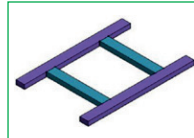
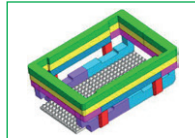

### Fluke 5725A

= core part + Adapter-3 + Adapter-4

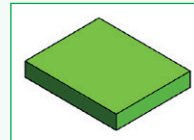
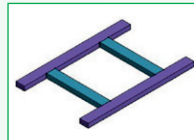
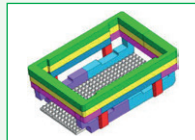

### Fluke 55x0A

= core part + 2x Adapter-1 (Smooth side pointing towards the measuring device) + Adapter-3

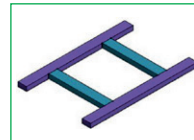
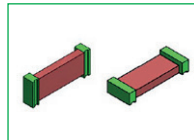
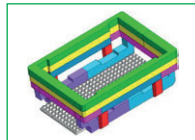

### Fluke 55x2A

= core part + 2x Adapter-1 (Recess pointing towards the measuring device) + Adapter-3

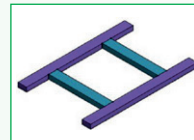
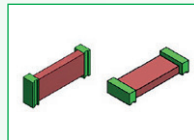
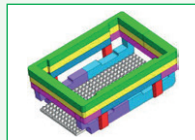

### Fluke 5320A

= core part + 1x Adapter-1 (Smooth side pointing towards the measuring device) + Adapter-3

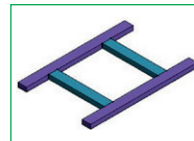
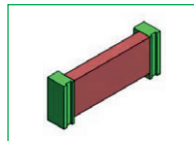
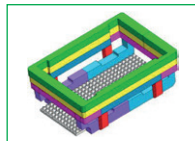

### Fluke 8508A

### Keysight 3458A

### Wavetek 9100

= core part + Adapter-2 + Adapter-3

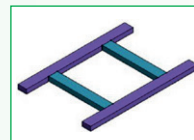
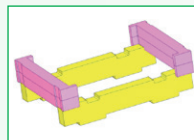
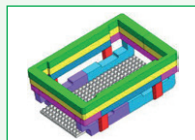

your distributor:

Minerva Metrology and Calibration

Chrysantstraat 1

3812 WX Amersfoort, the Netherlands

tel. +31 33 46 22 000

info@minerva-calibration.com

www.minerva-calibration.com